

Clip-on, 105 degree soft close hinges

7173101 / 7172102 / 7171103

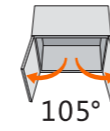

105°

Products overview



- Concealed hinge clip on with integrated silent system
- For door thickness of 14-22mm
- Cup diameter : 35mm
- Cup depth : 11.5mm
- Opening degree: 105°
- Hinge arm material : steel , nickel plated
- Hinge cup material : steel , nickel plated

Technical Specification



- Full overlay

7173101



- Half overlay

7172102



- Inset

7171103

Overlay table

Full overlay

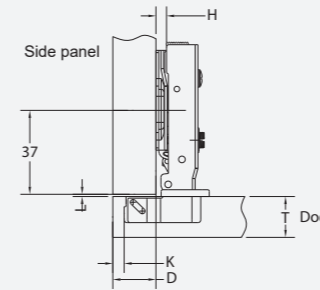

$$H=14+K-D \quad D: \text{maximum value}$$

D	K	3	4	5	6	7
0	17	18	19	20	21	
2	15	16	17	18	19	
4	13	14	15	16	17	

Half overlay

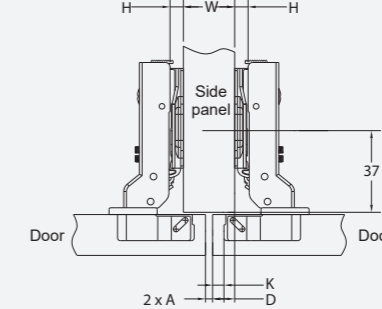

$$H=4+K-D \quad D: \text{maximum value}$$

D	K	3	4	5	6	7
0	7	8	9	10	11	
2	5	6	7	8	9	
4	3	4	5	6	7	

Inset

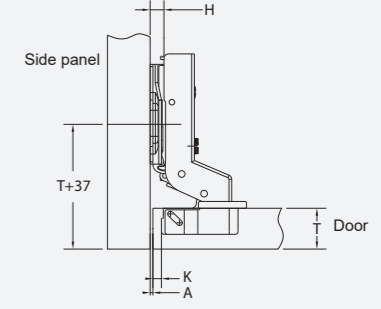

$$H= -4+K+A$$

A	K	3	4	5	6	7
0	1	0	-1	-2	-3	
2	3	2	0	0	-1	
4	5	4	3	2	1	

Drilling for Cup

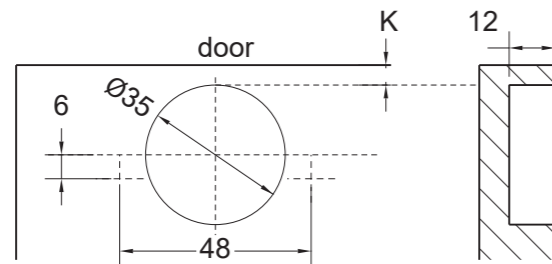

Cup Installation

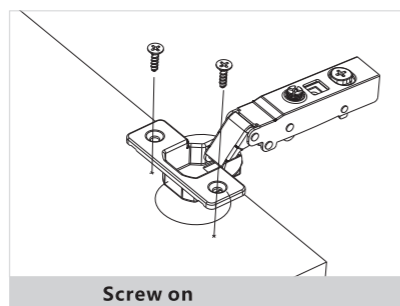

Screw on

Wood screws

5

Minimum reveal table

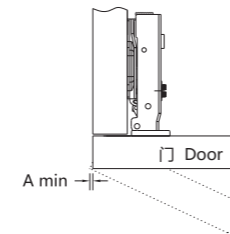

A	K	T	14	15	16	17	18	19	20	21	22
3	0.3	0.5	0.7	0.9	1.2	1.5	1.8	2.2	2.6		
4	0.3	0.5	0.7	0.9	1.1	1.4	1.8	2.1	2.5		
5	0.2	0.4	0.6	0.9	1.1	1.4	1.7	2.0	2.4		
6	0.2	0.4	0.6	0.8	1.1	1.3	1.6	2.0	2.4		
7	0.2	0.4	0.5	0.8	1.0	1.3	1.6	1.9	2.3		

K= (Boring distance)

T= (door thickness)

A= (minimum gap (A) for door with a door edge radius)

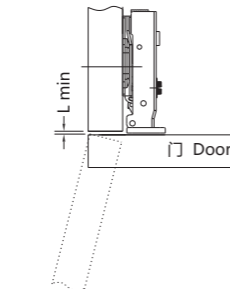

L	K	T	14	15	16	17	18	19	20	21	22
3	1.0	1.0	1.0	1.0	1.0	1.0	1.0	1.0	1.0	1.0	1.0
4	1.0	1.0	1.0	1.0	1.0	1.0	1.0	1.0	1.0	1.2	
5	1.0	1.0	1.0	1.0	1.0	1.3	1.5	1.8	2.0		
6	1.0	1.3	1.5	1.8	2.0	2.3	2.5	2.8	3.0		
7	2.0	2.3	2.5	2.7	3.0	3.2	3.5	3.7	3.9		

L= (gap between door and panel)

Note: above parameter based on the door edge is right-angle side, if the door is round corner edge, the parameter value will be reduce according to the edge size.

Hinge adjustment

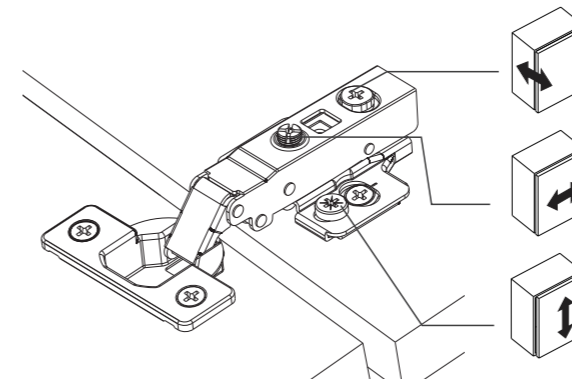

Depth adjustment

Rotate depth screw to adjust door gap.
Adjust range : 3.8mm (cam screw)
5mm (depth screw)

Overlay Adjustment

Rotate lateral screw to increase or decrease door overlay.
Adjust range : 6mm

Height adjustment

Adjust the mounting plate on panel to adjust the door's height.

Notice: The reference adjustment range is the product design range, the actual size of the cabinet and the drilling method may have a certain impact on the parameters.