

# USER MANUAL

[ DIGITAL DOOR LOCK ]

FINGERPRINT  
PASSWORD  
SMART KEY  
MECHANICAL KEY  
(OPTIONAL) REMOTE CONTROL

**The default password is 1234.**  
Please change to new password.  
Ensure not to use consecutive or repetitive numbers for your safety.

PTMP2011ONTA REV.02

## Safety Cautions

- Please read thoroughly before operating the product.
- For security, the passwords should be changed on a regular basis.
- When the batteries are inserted in reverse positions, it may result in liquid leakage or rupture.
- When the batteries are flat, all the batteries should be replaced; do not use new batteries with used ones.
- Do not install, disassemble or repair without the assistance of a product repair technician.
- Use a soft and dry cloth to clean the product.
- Do not press or insert the buttons with pins.
- Do not use the product for any purpose other than a digital door lock.
- Do not let water get into the product.
- Do not subject the product to any severe impact.

## Product Components

The product components may change depending on the installation environment.

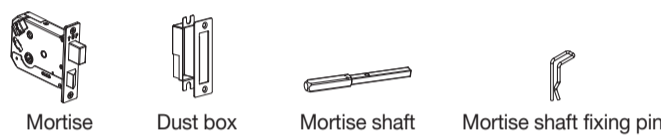
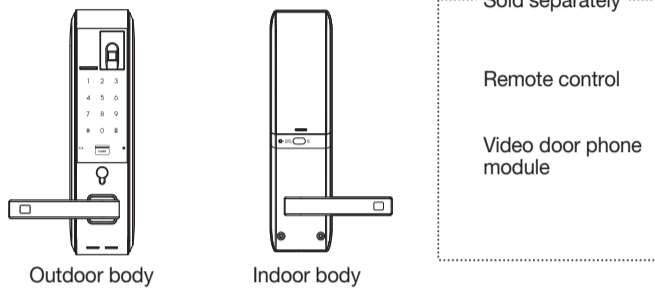

User manual  
Dimension guide  
'AA' Batteries (LR6) (8EA)  
Mechanical key (2EA)

Installation manual  
Smart keys  
Screws

## Caution

For emergency cases, please make sure leave more than one emergency key outside.

## Names of Individual Parts (Outdoor Body)

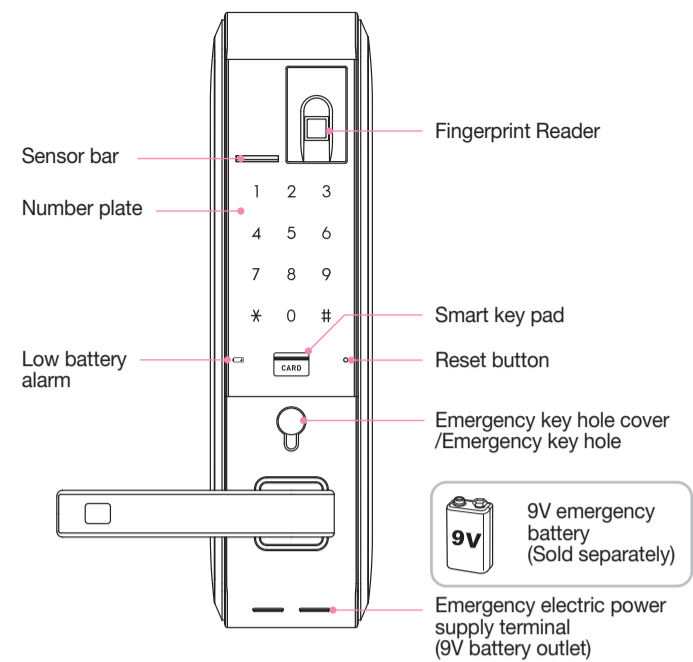

## Names of Individual Parts (Indoor Body)

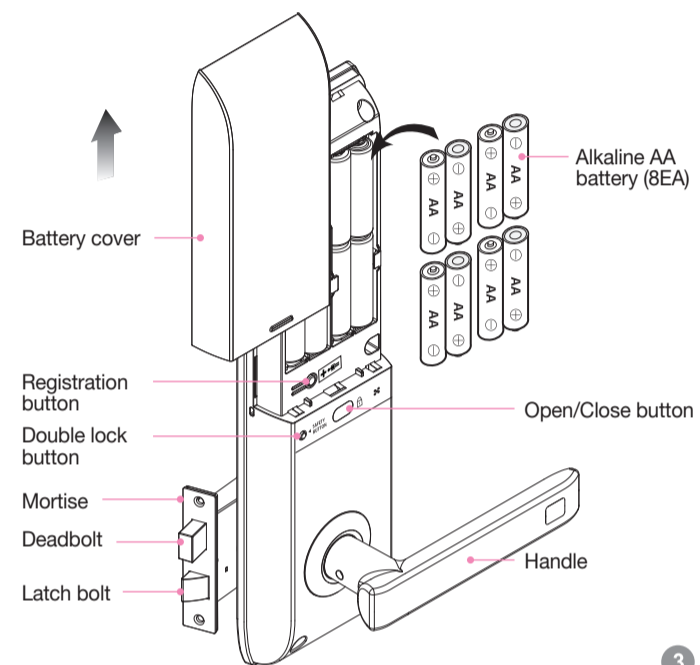

## How to Register/Change the Password

Ensure the door is open when registering/changing the password.

1. Open the battery cover and press "Registration" button.



Registration

2. Check whether the lamp on the number plate is lit.



3. Enter 4~12 digits for the password.



4. Press [\*] and when a beep sounds, the registration is complete.

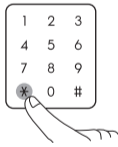

## CAUTION

After the registration/change of the password, press "Open/Close" button on the inside of the door while the door is open to release the deadbolt. Enter the new password + [\*] and ensure that the deadbolt retracts before closing the door. If the password is not entered within 10 seconds after the [Registration button] is pressed, the registration will be canceled. When the new password is registered, the previously registered password will be deleted automatically.

## NOTE

Adding new passwords (up to 4 passwords can be added) Before the lamp on the number plate goes out, enter the new password and repeat the steps 3 and 4 as above.

## How to Register/Change the Smart Keys

1. Open the battery cover and press "Registration" button.



Registration

2. Check whether the lamp on the number plate is lit.

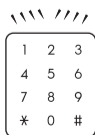

3. Tag the smart key onto the smart key touch pad. (check for a beep sound every time a new smart key is registered).

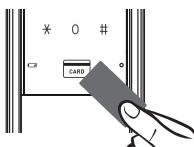

4. Press the "Registration" button and when a beep sounds, the registration is complete.



Registration

## CAUTION

When registering or re-registering smart keys, all smart keys need to be registered at the same time. Cards other than the smart keys provided, smartphones and credit cards with transportation card functions, and transportation cards cannot be registered. After pressing the "Registration" button, tag the smart key within 10 seconds, or the registration will be canceled. With the registration of new smart keys, previously registered smart keys will be deleted automatically.

## NOTE

Adding new smart keys (up to 100 can be registered) to register a multiple numbers of smart keys, tag the smart keys consecutively within 10 seconds after the registration of the first smart key.

## How to Register/Change the Fingerprint

## CAUTION

1. When registering new fingerprint, please delete the all pre-registered fingerprint because previously registered ones are not deleted when you register new fingerprint. (Refer to page 6)
2. When you register 100 fingerprint already, you cannot register new ones; please delete them first and register.

1. Open the battery cover and press "Registration" button.



Registration

2. Check whether the lamp on the number plate is lit.

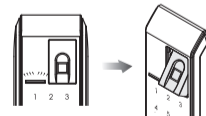

3. Place your finger on the fingerprint reader and scan for three times. You can listen to the beep sound after successfully reading your fingerprints. Also you can see the number of fingerprint on the number plate successfully read by the reader.



[Note: if the three fingerprints are not identified as same ones, you can hear beep sound and the registration process is not completed.]

4. Press the "Registration" button to complete.



Registration

## NOTE

Up to 100 fingerprints can be registered. To add more fingerprint, please repeat Step 3 and 4 before the lamp on the number plate goes out.

## CAUTION

1. During the process, if no additional input for 20 seconds, the registration process is canceled.
2. Damaged fingerprints and children's fingerprints can be difficult to register.
3. Please keep clean the fingerprint to read successfully.

## How to Delete Smart Keys

1. Open the battery cover and press "Registration" button.



Registration

2. When the number plate on the body outside of the door is lit, press [8] button.



3. Press [#] button for 5 seconds.

< 5 seconds.

## How to Delete Fingerprint

1. Open the battery cover and press "Registration" button.



Registration

2. Check whether the lamp on the number plate is lit. Press [9].



3. Press [#] button for 5 seconds to delete the all registered fingerprints.

< 5 seconds.

## Opening from Outside (with the Password)

1. Touch the number plate and then enter the password.
2. Touch [\*] and after a beep sound, the door will open.



## NOTE

The password needs to be entered while the light on the number plate is on, and if the number plate is unlit, touch the number plate. When an incorrect password is entered 5 times in a row, the door lock will be suspended for 1 minute with a warning sound. When the suspension is cleared, the door lock will function normally, and a correct password needs to be entered to open the door.

## Opening from Outside (with Smart Keys)

In Automatic Sensing Setting

Tag the smart key pad with a registered smart key (see page 9).

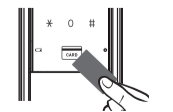

In Manual Sensing Setting

Touch the number plate, and when the lamp on the number plate lights up, tag the smart key pad with a registered smart key (see page 9).

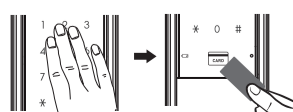

## Opening from Outside (Random Number Function)

Touch the number plate and then enter any numbers before entering the registered password and then press [**\***], or after entering a registered password, enter any number and press [**\***]. The door will open with a beep sound.

**NOTE** Entering this random number will be useful when concerned about possible exposure of the password. (When more than 20 digits including both the password and the random numbers are entered, an error alarm will sound, and the numbers will need to be entered again.)

**CAUTION** \* The multi-touch security function is deactivated when the product is purchased.

## Opening from Outside (with Fingerprints)

1. Please touch the sensor bar to tilt the fingerprint reader part.
2. Read the registered fingerprint.
3. After listening to the confirmation sound, you can open the door.

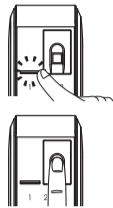

**NOTE** - If you try to unlock with unregistered fingerprint for five times, you cannot open the door for a minute.  
- Instead of touching the sensor, you can push the fingerprint reader to tilt the part.

## Locking from Outside

In auto lock function setting

When the door is closed, the door lock will function automatically within 2 seconds. (see page 9).

In manual lock function setting

Touch the number plate, and press [**#**] button. (see page 9).

## Opening from Inside

The door will open when the handle is pushed downwards.



**CAUTION** When the door is not opened 7 seconds after pushing the handle downwards, the door will be locked automatically. (In auto lock function setting)

## Locking from Inside

In automatic lock function setting  
The door lock will be locked 2 seconds after the door is closed. (see page 9).

In manual lock function setting  
When the door is unlocked, press "Open/Close" button on the body inside of the door and the door will be locked. **7**

## Setting Video Door Phone Module and/or Portable Remote Control

This is designed to open with a video door phone module/a remote control.

How to Register

1. Open the battery cover and press "Registration" button.

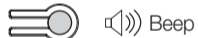

2. To register video door phone module: press the "Register" button.  
To register the remote control: press the "Open" button (up to 5 portable remote controls can be registered)

3. Touch the [**\***] button on the number plate to complete.



How to Delete

1. Open the battery cover and press "Registration" button.

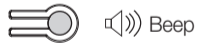

2. Press the [0] on the number plate.



3. Touch the [**#**] button for more than 5 seconds and all the registered information on the remote control will be deleted with a beep sound.



**NOTE** To add video door phone module and/or remote controller for registration, repeat #2 before the number plate light goes out (up to 5 can be entered).  
To use video door phone module, purchase a separate module to install.

**CAUTION** With registration of a new video door phone module, information of previous video door phone module will be deleted automatically.  
With registration of a new remote controller, please re-register cast-in-place clutch.  
When new video door phone module and/or remote controller are not registered within 10 seconds after "Register" button pressed, the registration will be canceled.

## Deadbolt Alarm

When opening/closing the door, if the deadbolt does not operate properly, 3 warning beeps in a row will sound.

**CAUTION** If the warning sound continues or if the product does not function properly, the position of the door lock needs to be re-adjusted. When this happens, contact a door lock technician for assistance.

## Forced Lock Function (Double Lock)

This function prevents opening from outside with either passwords or smart keys.

How to activate the function

With the door locked, press "Double Lock" button for 3 seconds until beep sounds.

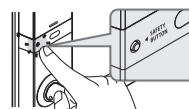

How to deactivate the function

Push the handle downwards to open the door from indoor side and then the double lock will be deactivated.

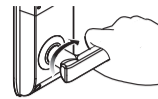

## Activating and Deactivating Door Lock Check Function

In the manual lock mode, the LED light will blink when the door is not locked. The LED light will not blink when the door is locked.

How to activate the function

Touch the number plate → Password → # → 2

How to deactivate the function

Touch the number plate → Password → # → 0

**NOTE** The light will blink twice to warn break-in or fire. To notify low battery, LED blinks once when the door is locked. This function is deactivated when the product is purchased.

## Volume Control

The sound volume can be adjusted (when the door is locked).

To Increase

Touch the number plate → Password → # → 3

To Decrease

Touch the number plate → Password → # → 6

**NOTE** Sound volume can be adjusted to 7 levels.

## Temporary Mute Function

Touch the number plate on the body outside of the door, press the [**#**] button and then enter the password or tag with a smart key for a temporary (once) mute function.

**NOTE** When the temporary mute function is activated, the number plate will blink with each touch. **8**

## Low Battery Alarm

When there are beeping sounds with a normal operation of the door, the batteries need to be replaced. Ensure all 8 of batteries replaced. (When the flat batteries are not replaced, the door lock may stop functioning.)

**CAUTION** When the batteries are flat, all of them need to be replaced. Do not use used batteries with new ones. (Do not mix batteries from different manufacturers.)

## Use of the Emergency Battery (9V)

When the batteries are completely flat, please use an emergency battery (9V).

1. Connect the battery to the emergency electric power supply terminal.
2. Touch the number plate and then enter the password. (Touch the number plate only when the number plate is not lit.)
3. Press the [**\***] button and with a beep sound, the product will be unlocked.

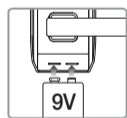

## Break-in Alarm

With the door locked, if the product senses any signs of abnormal attempts for opening, the alarm will go off with the alarm sound reaching 80db.

How to deactivate the warning alarm

Remove the batteries, enter the registered password or tag the registered smart key.

## High Temperature Alarm

If the product senses a high temperature with a risk of fire (62°C ± 5°C), an alarm will sound in high volume to ensure safety and the door will be unlocked automatically.

**CAUTION** If the body on the inside of the door is exposed to direct sunlight for many hours, the temperature sensor will become active, and the alarm may go off. Even if the door is set to "Double Lock Mode", the door will unlock automatically. When the product is at a high temperature, the door will not be unlocked.

## Prank Prevention Alarm and 1-minute Suspension

When unregistered password or smart keys are entered or tagged 5 times consecutively, the door will not function for 1 minute with an alarm sound.

## Automatic/Manual Lock Setting

This function is designed to lock the door automatically/manually.

1. Please open the door and release the deadbolt as picture.
2. Enter the password and then press [**#**] button twice in a row.
3. [4] button: will set the automatic lock.  
[7] button: will set the manual lock.

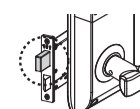

**NOTE** When it is set to the manual lock, the door will not be locked even when the door is closed. Either press "Open/Close" button on the body inside of the door or touch the number plate on the body outside of the door to lock.  
\* The product is set at automatic lock when the product is purchased.

## Smart Key Automatic/Manual Sensing Setting

This function is designed to sense the smart keys automatically/manually.

Automatic sensing setting

Touch the number plate → Password → # Twice → 1  
(Twice in a row)

Manual sensing setting

Touch the number plate → Password → # Twice → 3  
(Twice in a row)

**NOTE** With the automatic sensing setting, tag the smart key on the smart key pad to open. With the manual sensing setting, touch the number plate and then touch the smart keypad to open.  
\* The product is set to automatic sensing setting when the product is purchased.

## Emergency Key

This can be used when the door cannot be opened due to the door lock not working properly.

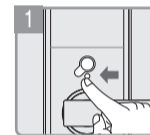

1 Push the emergency keyhole cover to the left.



2 Insert the emergency key in the keyhole and then turn either right or left.



3 When there is a 'click' sound in the deadbolt, return the emergency key back to its original position and then take it out.

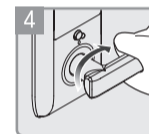

4 Push the handle downwards to open. Push the emergency keyhole cover back to the right. **9**

## Trouble Shooting

Trouble	Solution	Page
Cannot tune on the lock.	Please check the direction the batteries are inserted and check polarity marking. Please replace all 4 of the batteries (alkaline). Please check the battery status and/or the whether the battery is flat.	11
Cannot change password.	Touch the "Registration" button with a short beep sound. Refer to How to Register and/or Change password in the user manual.	4
Cannot open door even after entering the password with the [ <b>*</b> ] button touched.	Check whether the password is entered correctly. If the number plate lights are out while entering the password, the buttons cannot be touched; touch the number plate once again to light and then enter the password once again.	4
Registered information can be verified with the password/smart keys but the door does not open.	Use 9V emergency battery (square battery) for one more attempt. Locking device may be one of the major causes; contact technicians for assistance.	11
Cannot register fingerprint.	Please note that when you register fingerprint, you shall scan three times of your fingerprint. If three fingerprinted are not identified as same one, the registration process cannot be completed. During the registration process, if no additional input for 20 seconds, the registration process is canceled. If you registered already 100 fingerprint, you cannot add more. Damaged fingerprints and children's fingerprints can be difficult to register. Please keep clean the fingerprint to read successfully.	5
Cannot unlock the door with fingerprint.	Please check if the reading part is clean. If your fingers are wet, it can be very difficult to scan the fingerprint.	5
When being used, the product keeps making beeping sounds.	The alarming sound signals battery replacement. When there is the beeping sound, replace all the batteries (alkaline) with new ones.	11
Door does not lock automatically.	Please reset to auto lock mode. When the batteries are flat, the product will only make sounds but does not function. Please replace all 4 batteries (alkaline).	9, 11

## Product Specification

Item	Specifications	
Condition of Installation	Door thickness	40mm ~ 50mm
	Password	4-12 digits (up to 4 sets can be registered)
Opening Method	Smart key	Up to 100 can be registered.
	Fingerprint	Up to 100 can be registered.
Rated Voltage	DC 6V	LR6 1.5V AA size alkaline battery x 8EA
Emergency Electric Power	DC 9V	Alkaline battery (sold separately)
Sensing High Temperature	Temperature sensor type	72°C±5°C (laboratory environment) / 62°C±5°C (general environment)
Material	Outdoor body:	Al, Zn, ABS
	Indoor body:	Zn, ABS

\* The contents of this user guide are subject to change without prior notice in order to enhance performance of the product.